

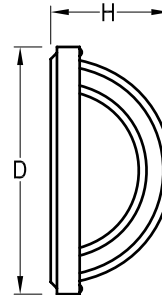

Fixture Specification

MODEL NUMBER: CGV JOB: _____ TYPE: _____



Light Source

Type	Twin Tube		Quad, Spiral or Triple			Triple		Diameter	Height
Wattage	9	13	13	18	26	32	42	10-1/4"	5"
Quantity	2	1/2	1/2	1/2	1	1	-	10-3/8"	5-1/4"
	2	1/2	-	1/2	1/2	1/2	-		

Standard Features

BASE	Injection Molded Polycarbonate 5" Luminaire Depth Aluminum 5-1/4" Luminaire Depth Mounts to Electric Box with Center Nipple	FINISH	Black	LENS	Opal White Polycarbonate UV Stabilized Non Yellowing Secured by Four Matching Black Screws
LAMP	Twin, Quad, and Triple - 2700K	ELECTRICAL	Electronic Ballast Normal Power Factor 120V-60Hz AC UL Listed Wet Location		

Special options

Please Note: Standard Features May Change if Fixtures are Ordered with Special Option(s).

BALLAST	<input type="checkbox"/> DV 120/277 <input type="checkbox"/> HPF High Power Factor <input type="checkbox"/> V 277 Volt	FINISH	<input type="checkbox"/> FW White	ACCESSORIES	<input type="checkbox"/> IPC Internal Photocell (on Luminaire 5-1/4" High) <input type="checkbox"/> BBX Back Box
KELVIN	<input type="checkbox"/> 3500K <input type="checkbox"/> 4100K	TECHNOLOGY	<input type="checkbox"/> GU24	COMPLIANCE	<input type="checkbox"/> ES www.energystar.gov for Qualified Models

ASL
25 Twelfth Street
Brooklyn, NY 11215-3820

Toll Free
Phone: 800-369-1101
Fax: 800-552-3465

Local
Phone: 718-369-1100
Fax: 718-369-1105

Online
email: info@aslighting.com
visit: www.aslighting.com



© copyright 2010 by American Scientific Lighting Corp. All rights reserved.

CGV