



LED FIXTURE SPECIFICATION

MODEL # **SAS-EMG**



FINAL MODEL #			
PROJECT			
TYPE		AREA	
NOTES			

STANDARD FEATURES: CEILING INDOOR

Fixture thermally tested to ensure longevity
 Maximum light distribution throughout lens
 Over current/voltage short circuit protection
 UL and/or CSA Compliant Listed
 Constant Current Design

FIXTURE	LED ENGINE
BASE Aluminum FINISH White LENS White Glass LOCATION Damp COMPLIANT RoHS LIFE HOURS 50,000 WARRANTY Limited 5 Years	LG/NICHIA/SAMSUNG, LED CHIPS LUMENS PER WATT AVG 100-120 @Module Efficacy KELVIN 27K 30K 35K 40K 50K CRI 80+ DRIVER 120 VOLTS 50/60Hz POWER FACTOR High TRIAC OR ELECTRONIC Low Voltage Dimming Down To 5% With Wall Box Dimmers TESTED LM80 and LM82

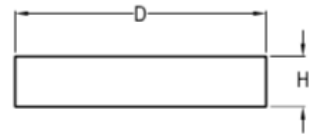

LED LIGHT SOURCE OPTIONS

ORDERING INFORMATION:

EXAMPLE		
WATTAGE: 12	KELVIN: 3000k	SIZE: 5x2
WATTAGE:	KELVIN:	SIZE:

SIZE OPTIONS	
D7	H2

SYSTEM WATTAGE	2700K WARM WHITE	3000K SOFT WHITE	3500K NEUTRAL	4000K COOL WHITE	5000K DAYLIGHT	LEGACY EQUIVALENT
10.5		600		600		
13.5		800		800		
18.5		1150		1150		

INSTALLATION (Nine simple steps.)

STEP1 Δ Turn-off / disconnect power at circuit breaker	STEP2 Attach connector (provided) to AC cable from Junction Box	STEP3 Remove the installation bracket from the back of the fixture	STEP4 Attach the bracket to Junction box using the 2 screws (provide d) – pull the AC cable with connector through the bracket center hole	STEP5 Next simply 'click' the two sides of the orange Wire Connector together	STEP6 Push and feed all wires up into Junction Box as you raise the fixture up into place	STEP7 Align slots on the edge of fixture with the ball bearings on the mounting bracket and PUSH to lock fixture in place	STEP8 Installed - Congratulations... Enjoy the light!

SPECIAL OPTIONS (please specify if applicable)

DRIVER: DVD	FINISH: FCU	LENS: LCU	ACCESSORIES: FUS	TECHNOLOGY: CT
DRIVER:	FINISH:	LENS:	ACCESSORIES:	TECHNOLOGY:

DRIVER	FINISH	LENS	ACCESSORIES	TECHNOLOGY
<input type="checkbox"/> DV 120/277 (Non Dimmable) <input type="checkbox"/> DVD 120/277 (0-10v Dimmable)	<input type="checkbox"/> FB Black <input type="checkbox"/> FBR Bronzestone <input type="checkbox"/> FCU Custom Any RAL Finish <input type="checkbox"/> FSN Satin Nickel <input type="checkbox"/> FW White	<input type="checkbox"/> LCU Custom	<input type="checkbox"/> CCS Cable, Cord Suspension System <input type="checkbox"/> CPS Cable, Pendant Suspension System <input type="checkbox"/> FI Finial <input type="checkbox"/> FUS Fused <input type="checkbox"/> IB Individually Boxed <input type="checkbox"/> PCH Pull Chain <input type="checkbox"/> PK1 Canopy/Pendant Kit/1 ROD <input type="checkbox"/> PK2 Canopy/Pendant Kit/2 RODS <input type="checkbox"/> PK3 Canopy/Pendant Kit/3 RODS <input type="checkbox"/> SRP Surge Protection	<input type="checkbox"/> BLD Bi-Level Dimming <input type="checkbox"/> CT LED Color Tuning <input type="checkbox"/> EMG Emergency (Any Lumens Package) <input type="checkbox"/> EMGR Emergency Remote <input type="checkbox"/> OS Occupancy Sensor On/Off <input type="checkbox"/> OSCD Occupancy Sensor Step Dimming

